

TYPE - 1
2 BHK 90 sq.m

This drawing is a copyright & the property of MAYA DESIGN GOA & is not to be copied or handed over to a third party or for use for any other purpose, other than for which it is handed.

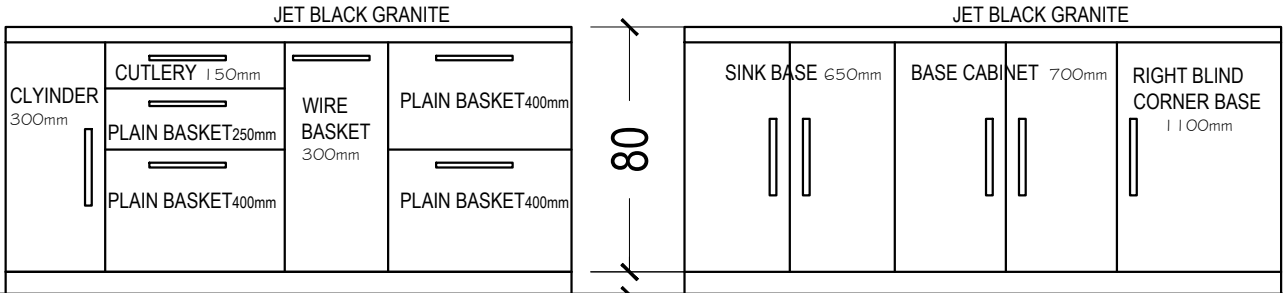

ELEVATION-A

7.5

ELEVATION-B

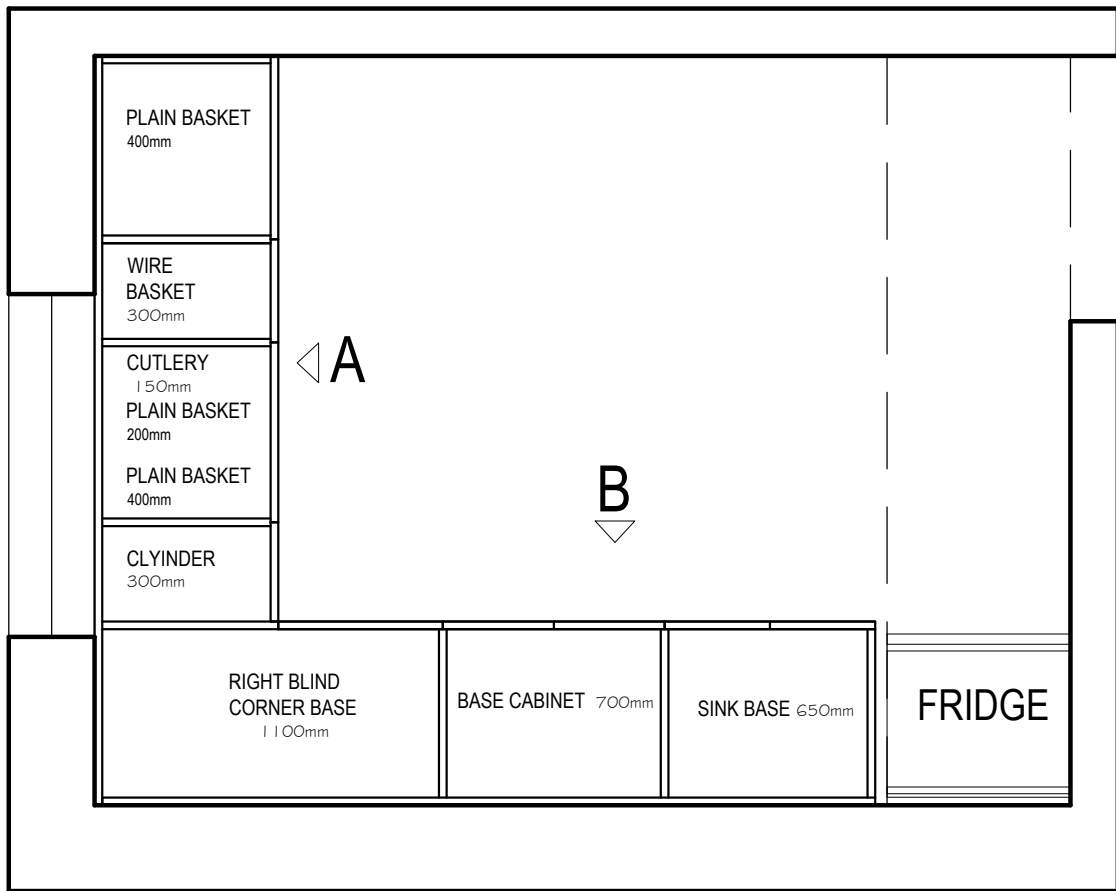

PROPOSED KITCHEN LAYOUT

REFERENCE : PRICE BID(PARTII) TYPE 1 (90 SQM) / B-INTERIOR WORKS / SR. NO. 7

Title : PROPOSED KITCHEN LAYOUT FOR TYPE - 1 (2BHK -90sq.m)

Date : 31-10-2016

Client : Nabard, Goa Regional office

Drg No : PL/01/006

Project : Renovation of Staff Quarters of Goa RO at Milroc Ribandar Retreat

Scale : NTS

Drn By : Ar.Mamta Jain

MAYA DESIGN GOA
Ar.Yatin Jain
905, PUNDALIK NAGAR,
ALTO PORVORIM,
BARDEZ,
GOA-403521
Tel: (0832) 2411145
Mb: 08975380333
email:yatin@mayadesigngoa.co.in